

RIGHT WEIGH



Installation Manual

MOUNTING BRACKET KIT

FOR 250 SERIES LIQUID FILLED GAUGES | 250-BR

For additional support contact:

United States and Canada:

Right Weigh, Inc.
(888) 818-2058
www.rwls.com
support@rwls.com

Australia and New Zealand:

Smart Truck Solutions
+61 418 622840
rightweigh.com.au

RIGHT WEIGH



Right Weigh, Inc.
Hillsboro, Oregon USA

PP-003-0050 Rev A
February 2020

©2015-2020 Right Weigh, Inc. All rights reserved.

WELCOME

Thank you for choosing to drive more and scale less! Here at Right Weigh, we are committed to making our products simple to install and easy to use. We understand that installation can vary between vehicles and yours may not be described in this manual. In any event, our technical support team is ready to answer your questions!



(503) 628-0838

(888) 818-2058 - Toll Free (USA ONLY)

+61 418 622840 - Australia & New Zealand



Email: support@rwls.com



www.rwls.com/how-to-calibrate-install/

rightweigh.com.au - Australia & New Zealand

FOLLOW US!



1 MOUNT BRACKET

Choose a location to mount the scale that is easily accessible and safe from potential damage (forklift posts, tire caps, etc.). Mount the bracket in the chosen location using two bolts to secure it.

2 INSTALL SCALE INTO BACKET

Install the gauge into the bracket as shown in the corresponding diagrams. Make sure to tighten all hardware securely.

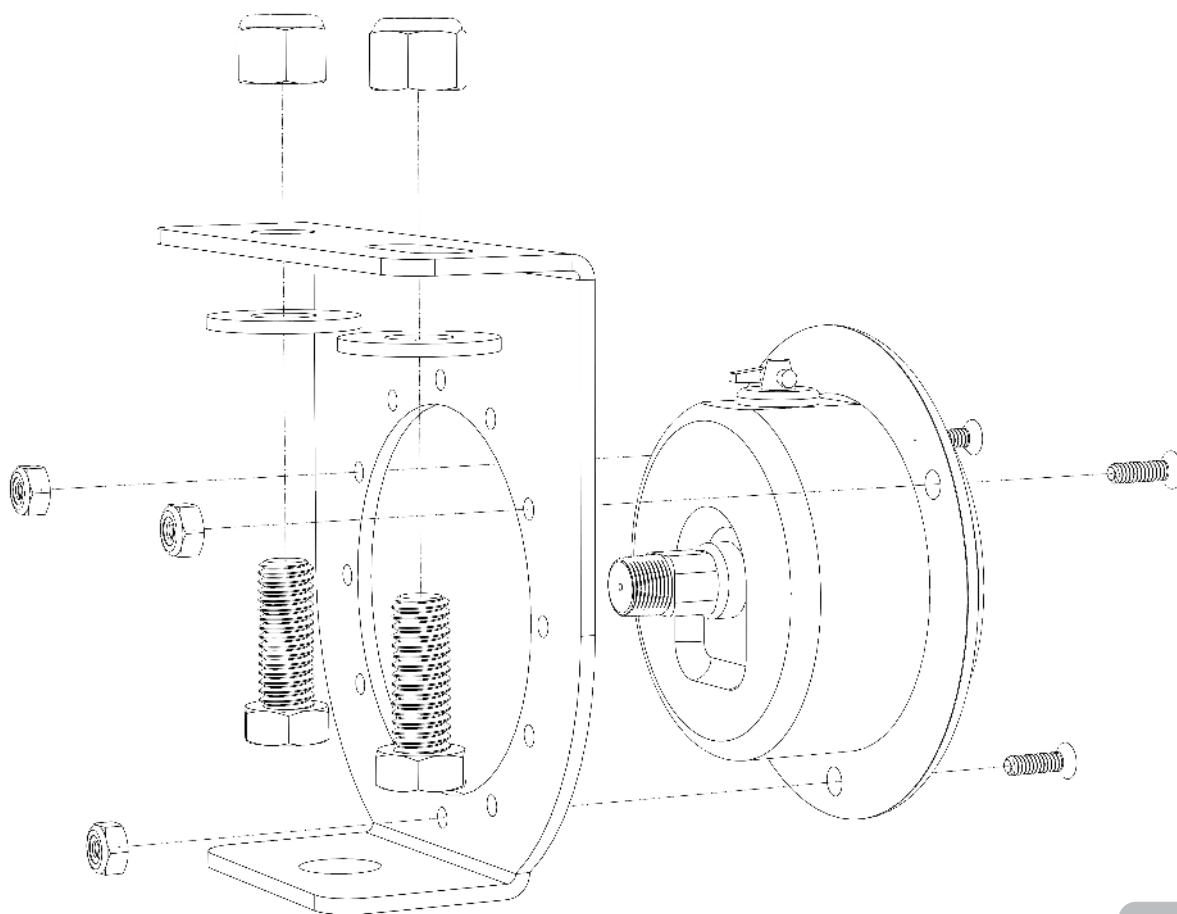

250-FF (Front Flange) Gauges

250-LM (Lower Mount) Gauges

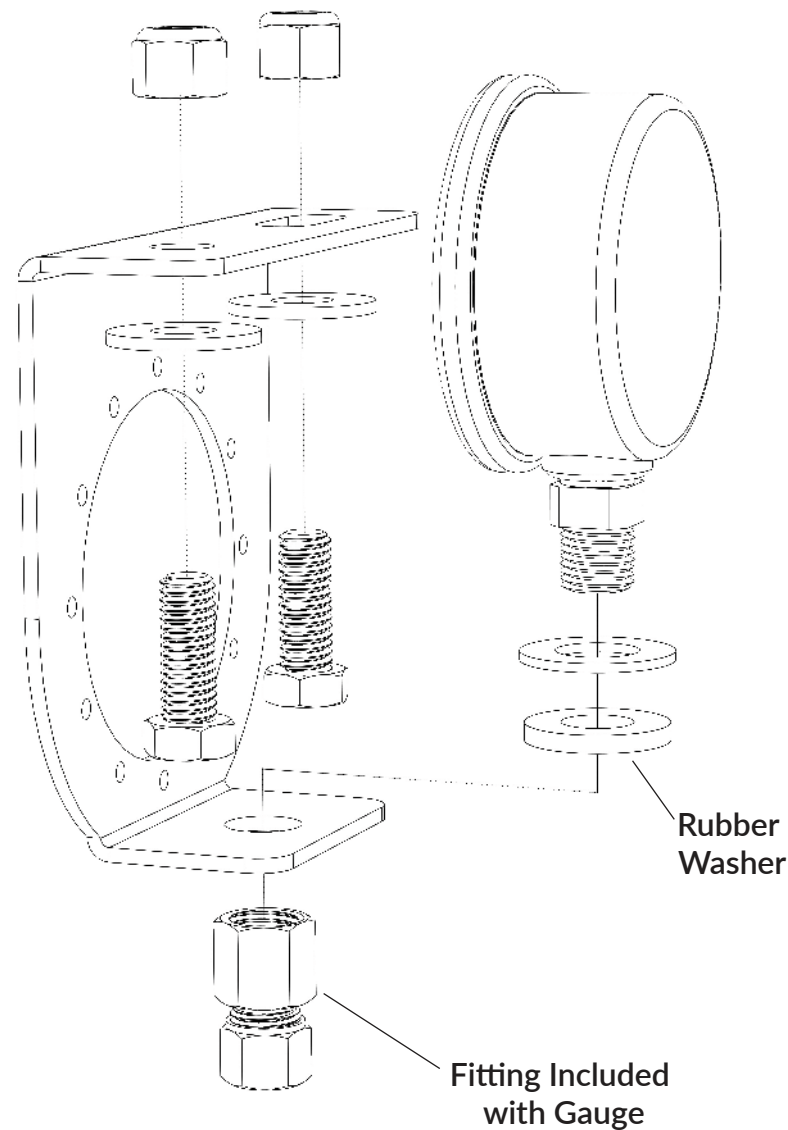

DO NOT cut or drill into the chassis or any other main beam unless it is approved by the vehicle manufacturer. Doing so may void the warranty with the vehicle manufacturer.